

# Bear Creek Cemetery -- Section A

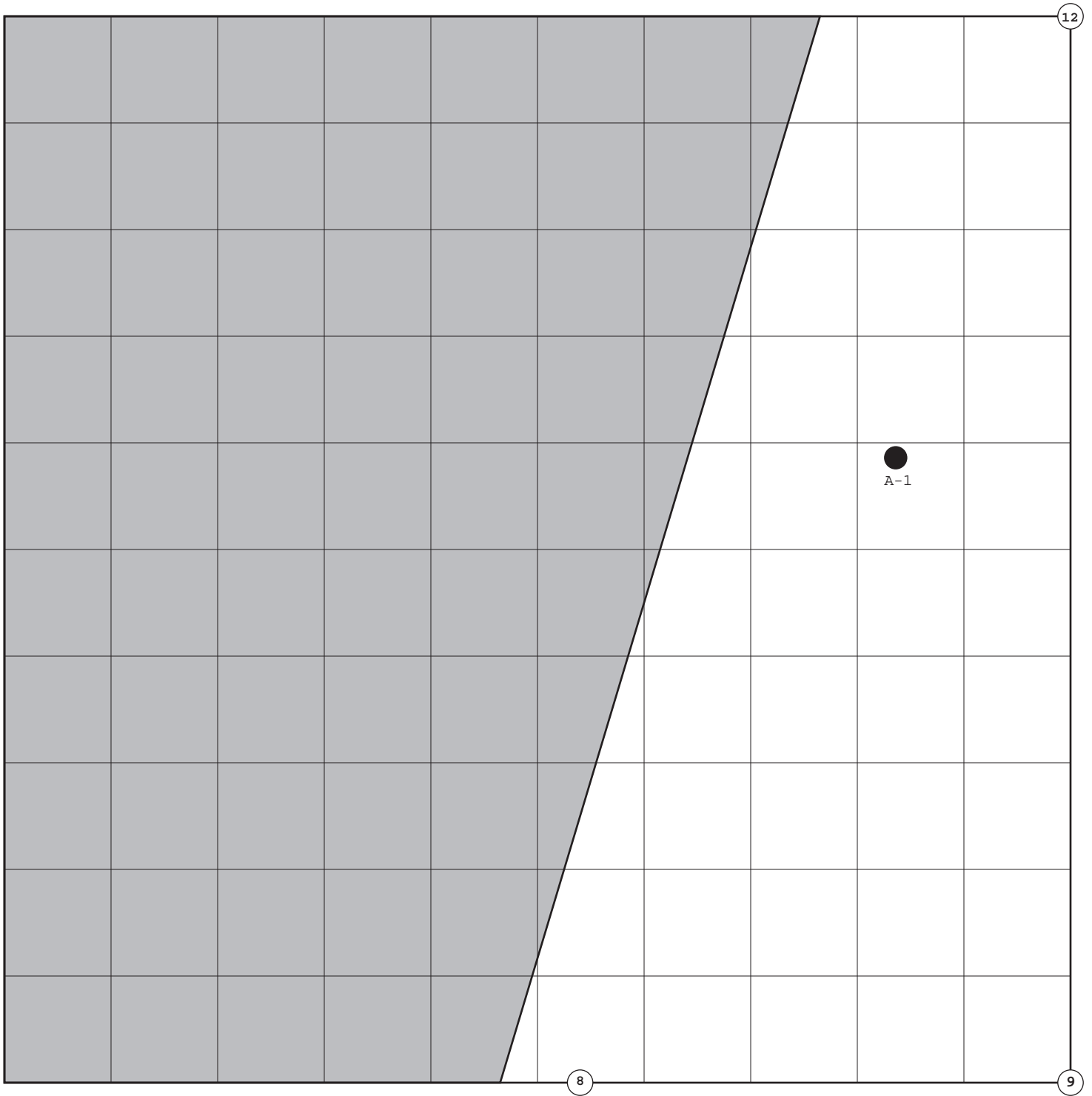

A-1 (Tree with "E" carved on trunk)

# Bear Creek Cemetery -- Section B

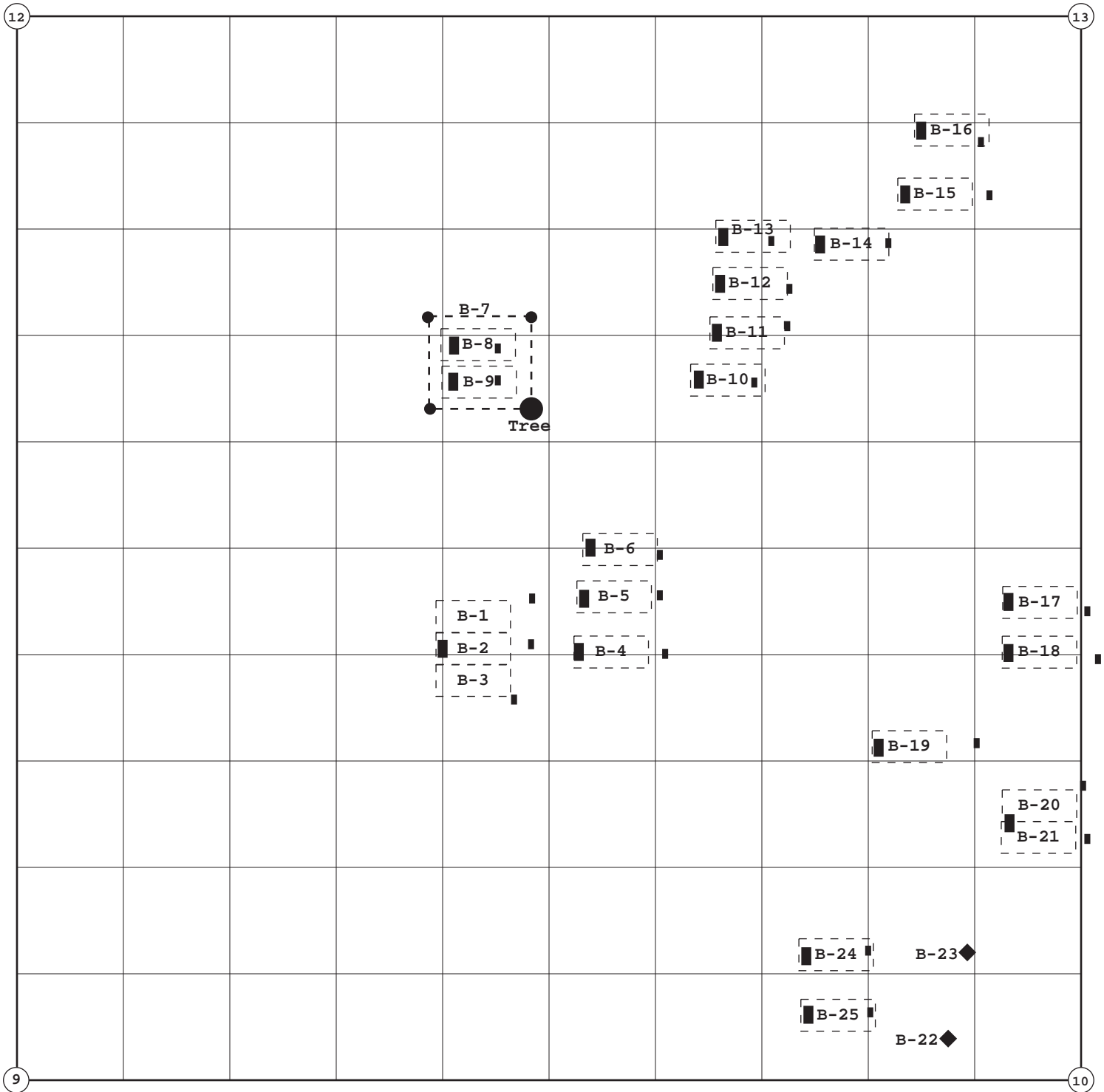

- B-1 Sarah E. Mayfield (SEM)
- B-2 Leroy Mayfield (LDM)
- B-3 Easter Mayfield (EM)
- B-4 Jane E. Morris (JEM)
- B-5 Harriett Morris (HM)
- B-6 Mary E. A. Lovell
- B-7 (Fence around B-8 and B-9)
- B-8 (Baker) (JB)
- B-9 Willie Baker (WB)
- B-10 Lela Hargrave (LH)
- B-11 Richard Hargrave (RH)
- B-12 Elizabeth Ann Hargrave
- B-13 Lucy E. Tisdale (LET)
- B-14 Collin Carey (CC)

- B-15 Elizabeth A. Burns (EAB)
- B-16 B. W. Burns
- B-17 Elizabeth Gist (EG)
- B-18 Martha S. wife of G. R. Welborn (CFL)
- B-19 J. W. McDaniel (JWM)
- B-20 Luro Welborn (LW)
- B-21 Martha Welborn
- B-22 (Field Stone)
- B-23 (Field Stone)
- B-24 inf. dau. of JE and MJ Davis
- B-25 Laurence Davis

# Bear Creek Cemetery -- Section C

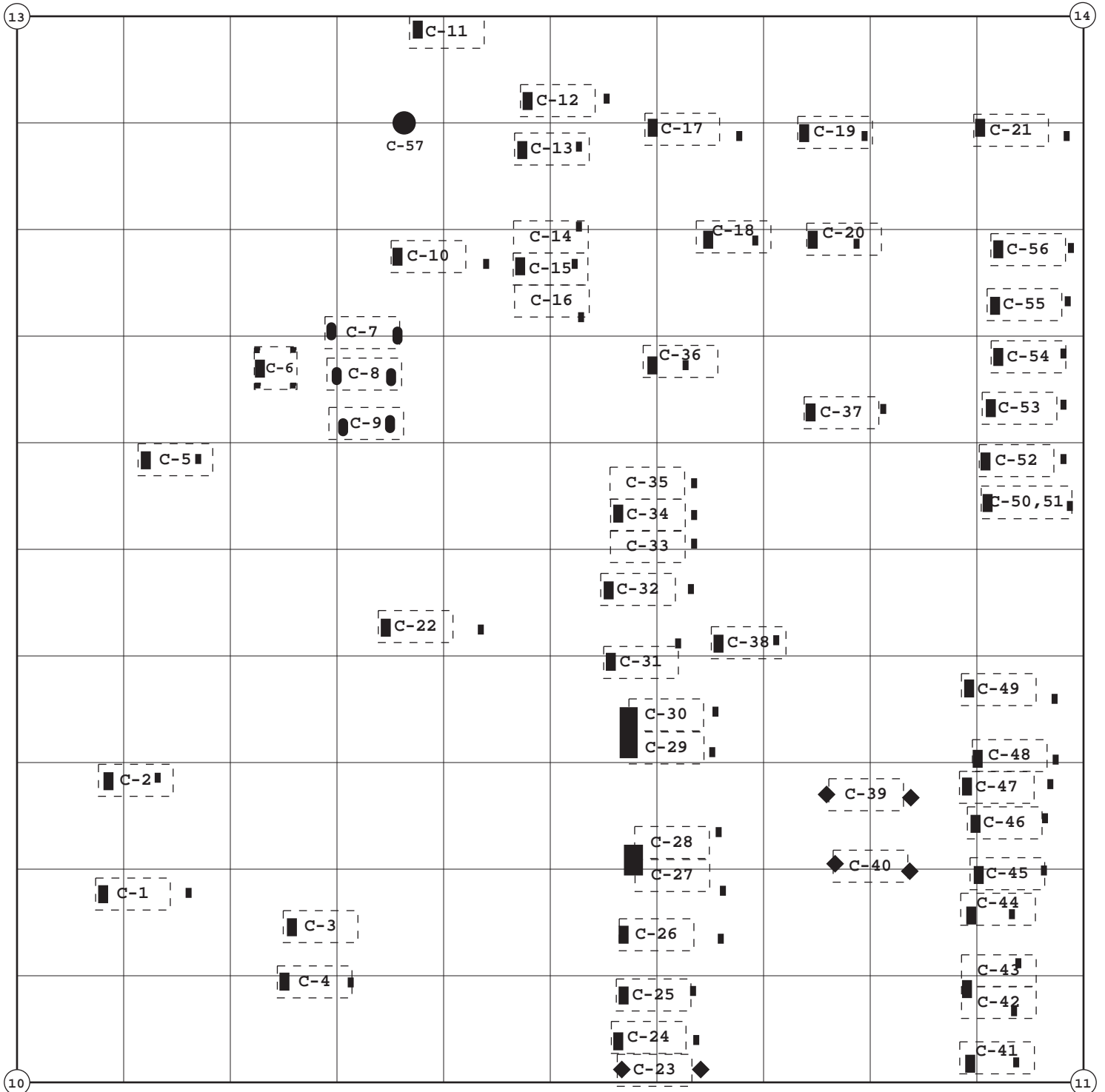

- |                                    |                                 |  |
|------------------------------------|---------------------------------|--|
| C-1 Sallie Stanford (SES)          | C-20 Ruben Stallings (ROS)      | C-39 (Field Stone)                     |
| C-2 Maddie Stanford (MMS)          | C-21 Frances White (FW)         | C-40 (Field Stone)                     |
| C-3 E. F. Barnett                  | C-22 Josiah Grubb (JG)          | C-41 Infant dau of HW & ML Harless     |
| C-4 Bennie F. Barnett (BFB)        | C-23 (Field Stone)              | C-42 Paul Harless                      |
| C-5 Grace B. Brown (GBB)           | C-24 Fannie M. Bond (FMB)       | C-43 Infant son of HW & ML Harless     |
| C-6 Nowlin (plaque: two babies)    | C-25 Mary Bond (MMB)            | C-44 John H. Harless (JHH)             |
| C-7 Nowlin (Bois d'Arc posts)      | C-26 Mary Lula Harless          | C-45 Mary M. Harless (MH)              |
| C-8 Nowlin (Bois d'Arc posts)      | C-27 Dr. J. L. Brockman (JLB)   | C-46 Henry C. Harless (HCH)            |
| C-9 Nowlin (Bois d'Arc posts)      | C-28 M. A. Brockman (MAB)       | C-47 Henry C. & Martha T. Harless      |
| C-10 Henry B. Reinhardt (HBR)      | C-29 T. P. Yeager (TPY)         | C-48 Martha T. Harless (MTH)           |
| C-11 Mattie J. Reinhardt           | C-30 Elizabeth Yeager (EY)      | C-49 U. C. Harless (UCH)               |
| C-12 Nancy Crenshaw (NAMC)         | C-31 Martha C. Yeager (MCY)     | C-50 Dr. S. L. Robinson (SLR)          |
| C-13 Lillie May Crenshaw (LMC)     | C-32 C. E. Yeager (CEY)         | C-51 H. B. Robinson                    |
| C-14 Reinhardt, infant son (IR)    | C-33 Edward Puckett (IEP)       | C-52 Samuel I. Robinson (SIR)          |
| C-15 Laura Reinhardt (LR)          | C-34 Ruth Puckett (RAP)         | C-53 MB dau. of SL & HB Robinson (MBR) |
| C-16 John H. Reinhardt (JHR)       | C-35 Henry S. Puckett (HSP)     | C-54 H. O. Robinson (HOR)              |
| C-17 Louisa T. Davis (LTD)         | C-36 Dennis V. Belw (DVB)       | C-55 Jerome Robinson (JR)              |
| C-18 Robert Turner Stallings (RTS) | C-37 William D. Stallings (WDS) | C-56 Ila Robinson (IR)                 |
| C-19 Lee Freeman (LM)              | C-38 (Broken Marker) (MFT)      | C-57 (Tree with "Z" carved on trunk)   |

# Bear Creek Cemetery -- Section D

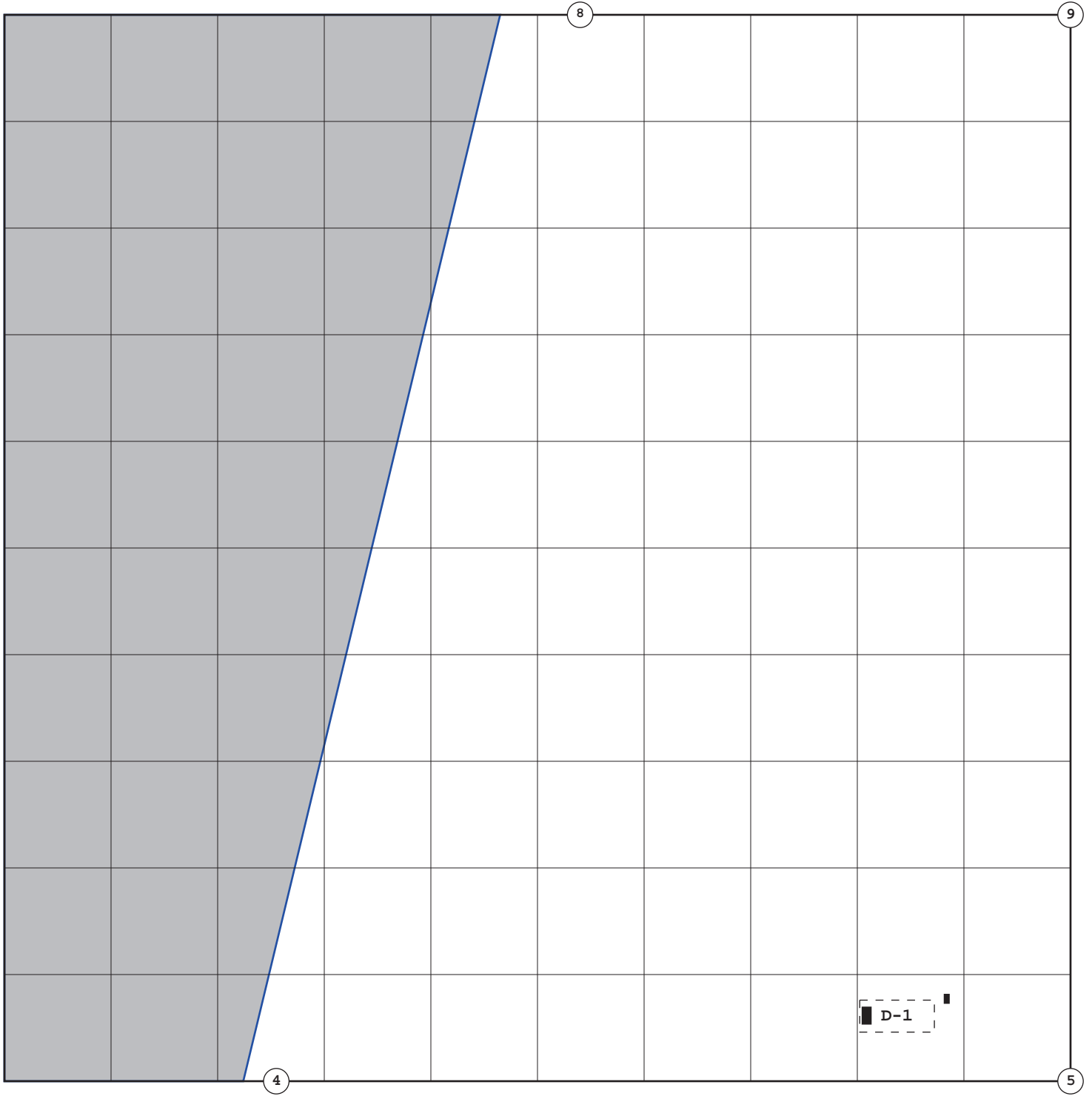

D-1 Lanora Brumfield McDugald

# Bear Creek Cemetery -- Section E

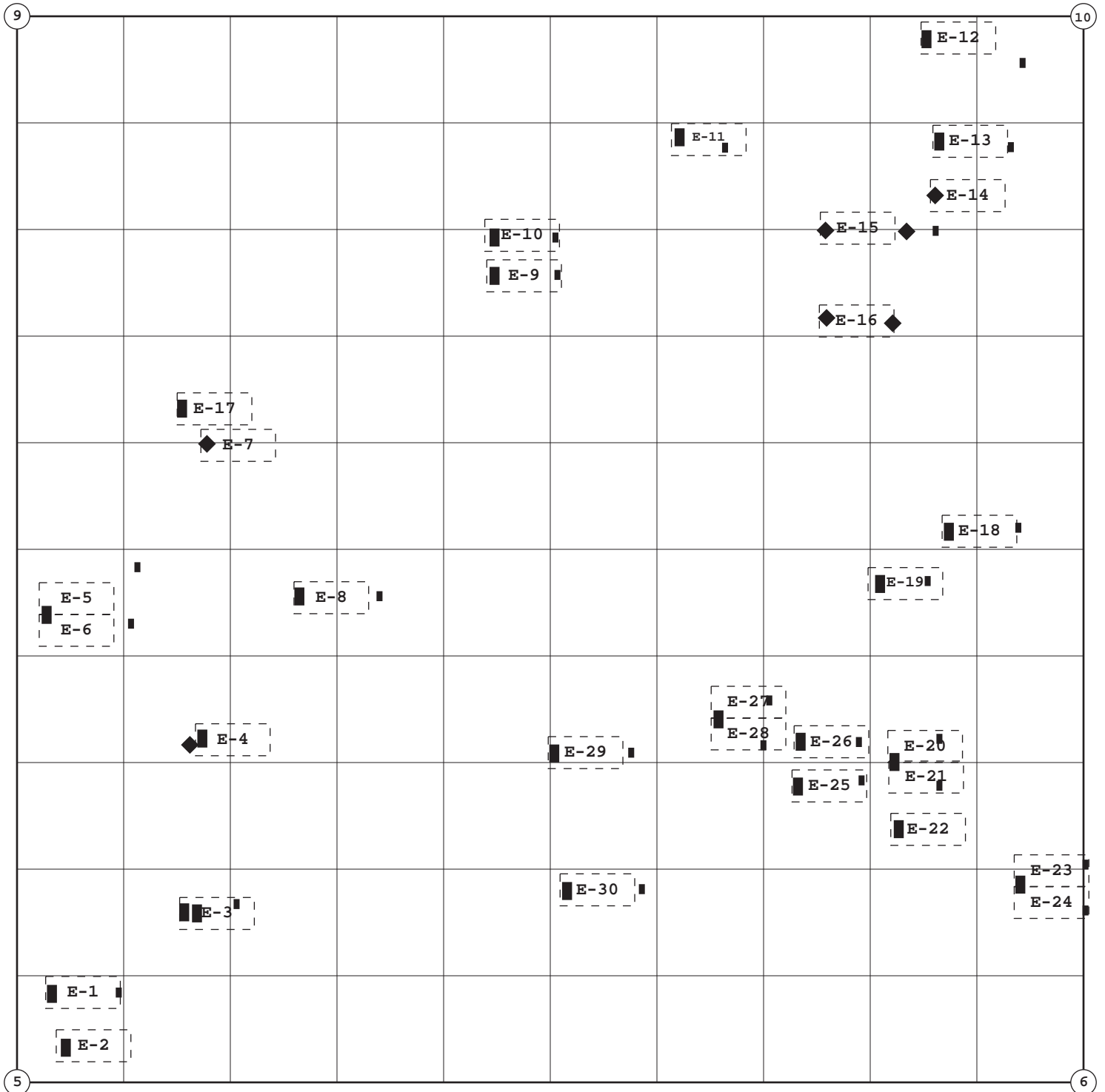

- E-1 Son of S.S. & Kate Daniel (ID)
- E-2 Son of S.S. & Sarah Daniel
- E-3 Bettie Welborn w/field stone
- E-4 Willie Welborn (field stone surr. by bricks)
- E-5 David W. Edmiaston
- E-6 Georgia A. Edmiaston
- E-7 (Field Stone) McClendon?
- E-8 Mattie Daniel
- E-9 Oddie Templeton
- E-10 C. H. L. Templeton (CHL)
- E-11 Margaret O. Gay (MOG)
- E-12 Mary Clifft (MC)
- E-13 Margaret L. Jones Clifft
- E-14 (Field Stone)
- E-15 (Field Stones, head and foot)
- E-16 (Field Stones, head and foot)

- E-17 Welborn
- E-18 Emma Walters (EW)
- E-19 Claudie Barringer (son) (CB)
- E-20 John E. Webb
- E-21 Minnie Webb (MEW)
- E-22 Edna Webb
- E-23 Avis Robinson (AR)
- E-24 Gladys Robinson (GR)
- E-25 Inf. son of L & SE Dale
- E-26 J. P. Dale son of
- E-27 Lula May Jones
- E-28 Inf dau. of J.B. & Isabella Jones
- E-29 Martha Weatherall
- E-30 Arlena Day (AD)

# Bear Creek Cemetery -- Section F

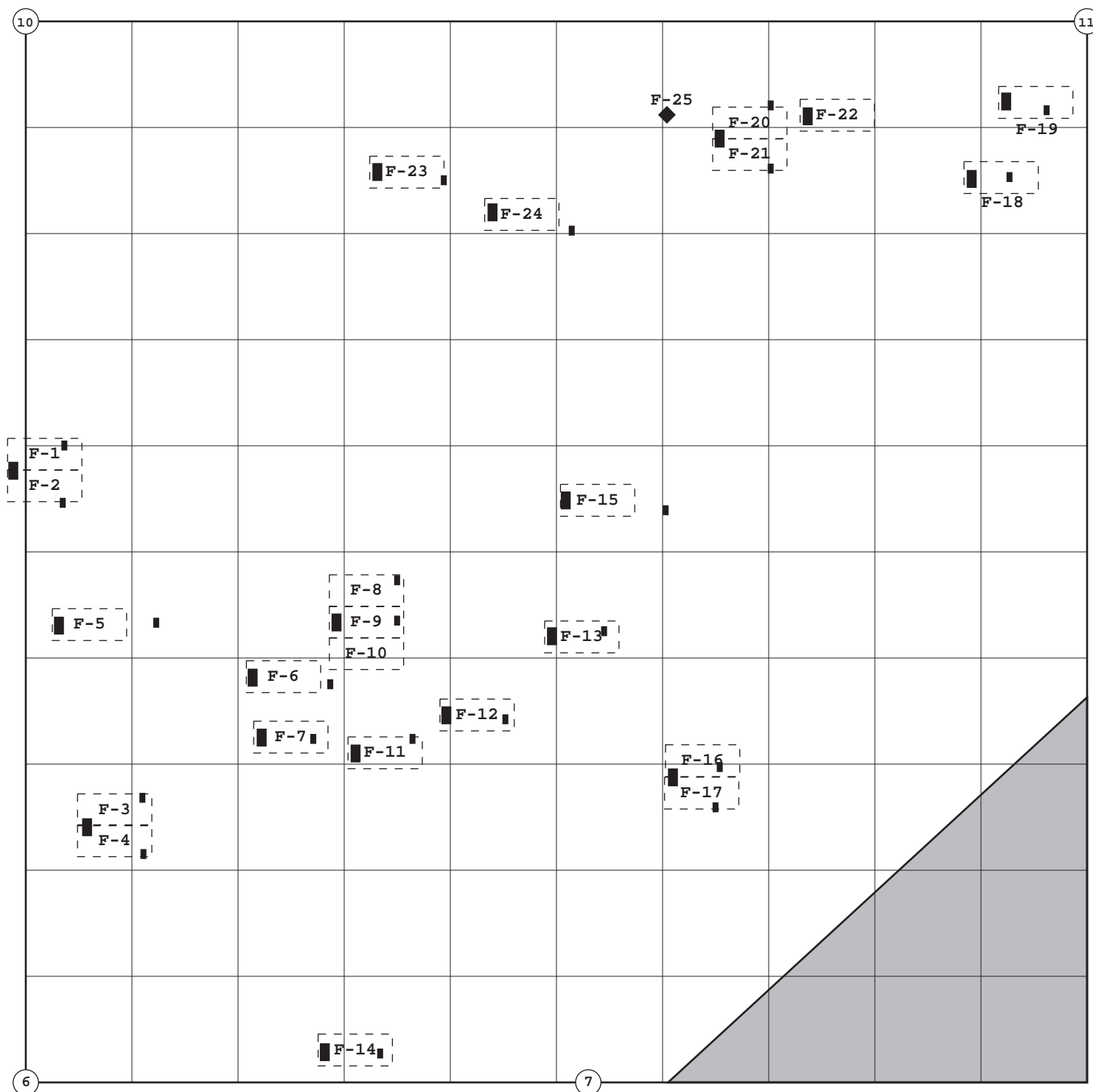

F-1 Della Corry  
 F-2 Martha Corry (MC)  
 F-3 Mary Crow Robinson (MCR)  
 F-4 David Guy Robinson  
 F-5 W. H. Buchanan (WHB)  
 F-6 Mary A. Stimson (MAS)  
 F-7 Pearl H. Stimson (PHS)  
 F-8 Maud A. Puckett (MAP)  
 F-9 Ortho H. Puckett (OHP)  
 F-10 Joseph Hodnett  
 F-11 Susie Stimson (STS)  
 F-12 Emmett Puckett (EHP)  
 F-13 William I. Graves (WG)  
 F-14 W. A. Moore

F-15 Janie Robinson (JR)  
 F-16 Ellie Chenoweth (EC)  
 F-17 Roswell Chenoweth (RC)  
 F-18 Mary M. Harris  
 F-19 Margaret Harris  
 F-20 Bobby Waddill (BW)  
 F-21 Willous Waddill (WHW)  
 F-22 John B. Harless  
 F-23 Jimmy Lee Horton  
 F-24 N. D. Geren (NDG)  
 F-25 (Field Stone)

# Bear Creek Cemetery -- Section G

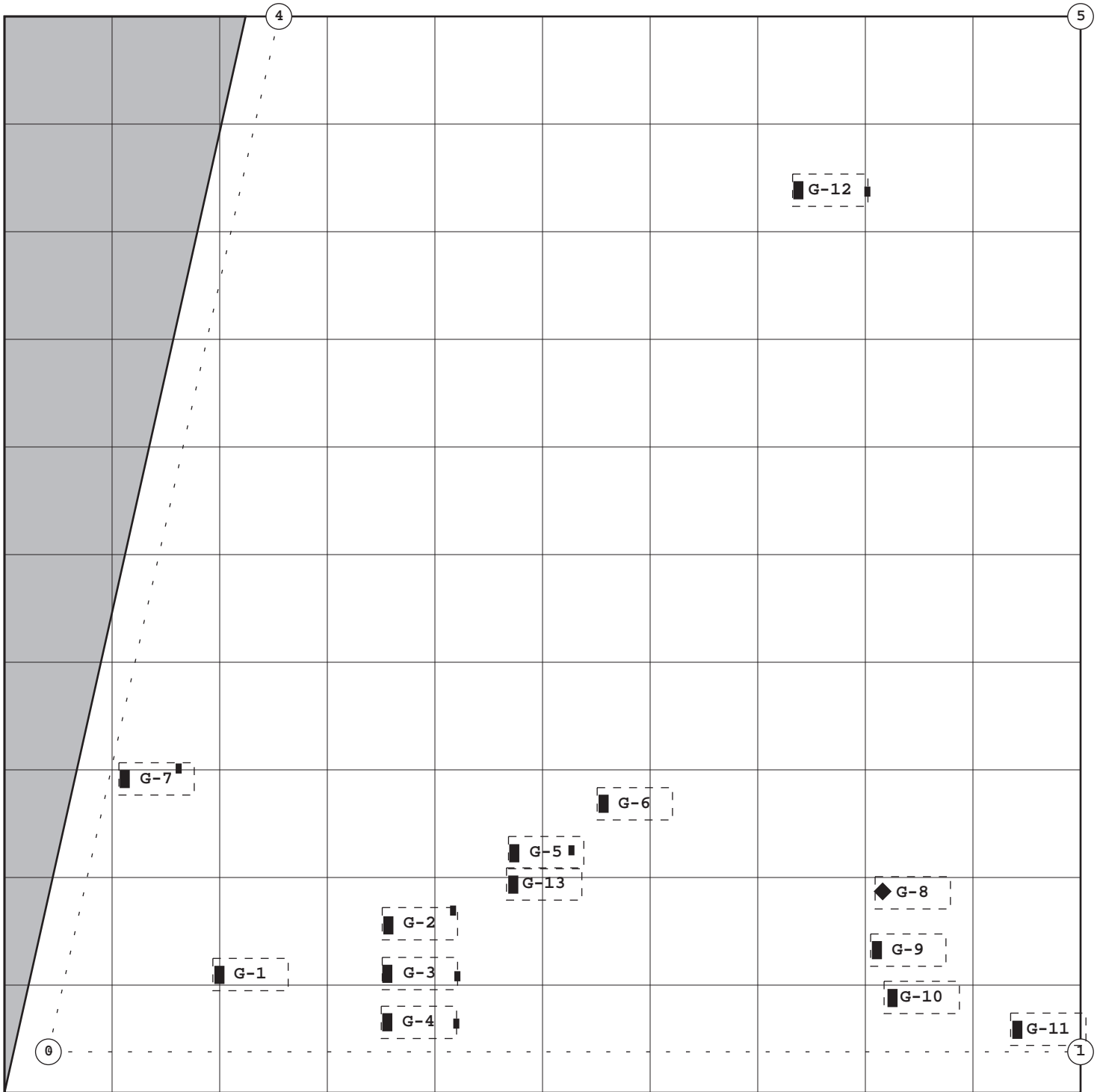

- G-1 Riley A. Turner
- G-2 Infant son Turner
- G-3 Lucy A. Turner
- G-4 Margaret A. Hall
- G-5 Dora E. Shipp (DES)
- G-6 Sarah E. Hall
- G-7 Gertrude Goode (GLG)
- G-8 (Field Stone)
- G-9 Samuel Evans
- G-10 Carl Evans
- G-11 (Broken Stone)
- G-12 Etter Irene McIntire (EIM)
- G-13 (Marker Base, no stone)

# Bear Creek Cemetery -- Section H

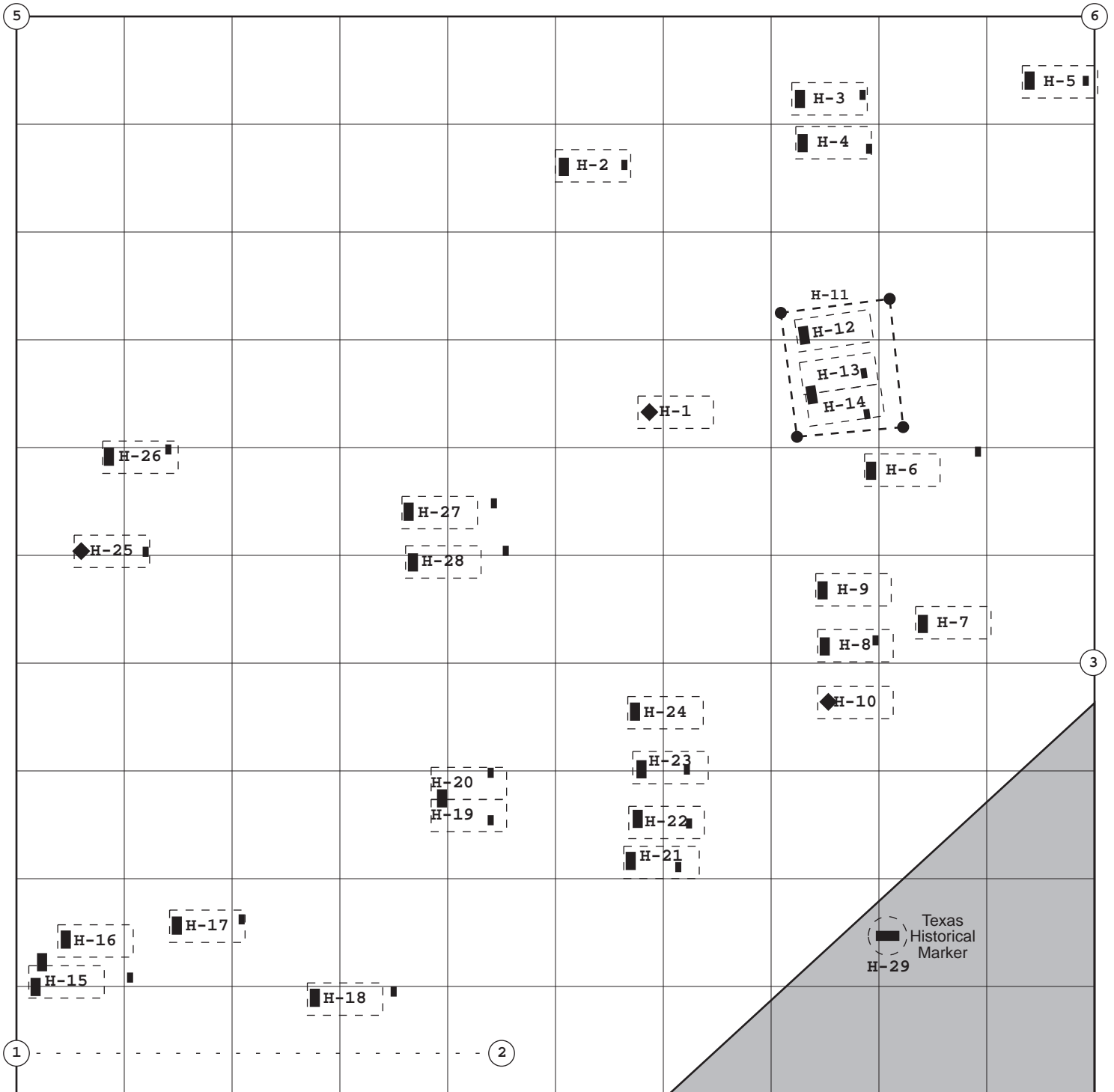

H-1 (Field Stone)  
 H-2 Fannie Taylor (FLT)  
 H-3 Jessie Opal Habern  
 H-4 James Garrett  
 H-5 Joseph F. Pegram (JFP)  
 H-6 J. G. Taggart (JGT)  
 H-7 Oscar Taggart  
 H-8 Orvie Taggart (OBT)  
 H-9 Virginia Taggart  
 H-10 (Field Stone)  
 H-11 (Fence Section)  
 H-12 Mrs. M. J. Brummett  
 H-13 Honard McClendon (HPM)  
 H-14 Infant son McClendon  
 H-15 Roswell Biggers (Bro. Biggers)  
 H-16 Mary B. Blount

H-17 Ada M. Harless (AMH)  
 H-18 L. C. Welborn  
 H-19 Orlen Harless (HOH)  
 H-20 Sammy Harless (SJH)  
 H-21 Girtie Martin (GM)  
 H-22 Allie Martin (AMM)  
 H-23 Dewey Martin (DM)  
 H-24 James Martin  
 H-25 (Field Stone and footstone)  
 H-26 J. Mc. H. Faulconer (JMCHF)  
 H-27 Leonard S. Jones (LSJ)  
 H-28 John T. Jones  
 H-29 (Texas Historical Marker)



# Bear Creek Cemetery -- Section I

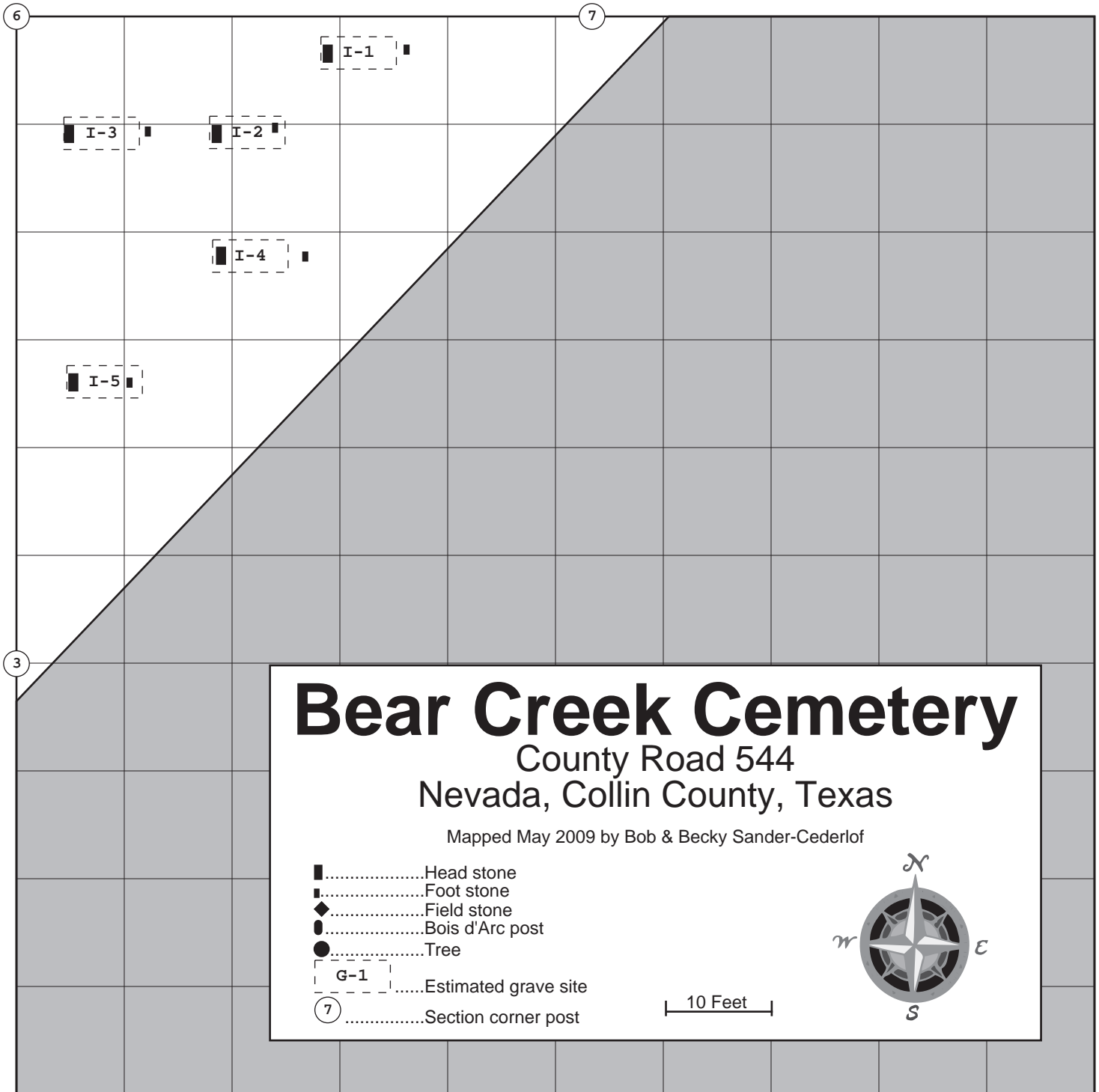

## Bear Creek Cemetery

County Road 544  
Nevada, Collin County, Texas

Mapped May 2009 by Bob & Becky Sander-Cederlof

- ..... Head stone
- ..... Foot stone
- ◆ ..... Field stone
- ..... Bois d'Arc post
- ..... Tree
- ⌈ G-1 ⌋ ..... Estimated grave site
- ⑦ ..... Section corner post

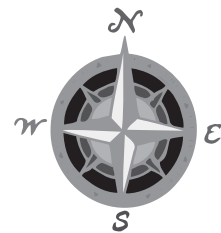

10 Feet

- I-1 Emma Sims (ES)
- I-2 S. A. Blalock (SAB)
- I-3 Elizabeth A. Box (EAB)
- I-4 Rebecker Casey (RC)
- I-5 Lorena Basham